

2 Guiding systems

Shaft guidings – standard series, closed types

LBCD ..

Standard series 3

Linear ball bearings self-aligning, closed type

LBCD ..A (without seals)

-LS with one seal

-2LS with two seals

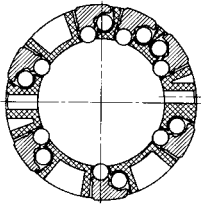
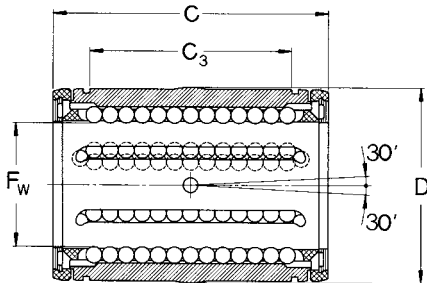

| Designations | Dimensions | | | | Basic load ratings | |
|-----------------|----------------|----|-----|----------------|--------------------|--------|
| | F _w | D | C | C ₃ | dynamic | static |
| | mm | | | | N | |
| LBCD 12 A | 12 | 22 | 32 | 20 | 1 080 | 815 |
| LBCD 16 A | 16 | 26 | 36 | 22 | 1 320 | 865 |
| LBCD 20 A | 20 | 32 | 45 | 28 | 2 000 | 1 370 |
| LBCD 25 A | 25 | 40 | 58 | 40 | 2 900 | 2 040 |
| LBCD 30 A | 30 | 47 | 68 | 48 | 4 650 | 3 250 |
| LBCD 40 A | 40 | 62 | 80 | 56 | 7 800 | 5 200 |
| LBCD 50 A | 50 | 75 | 100 | 72 | 11 200 | 6 950 |
| Example: | | | | | | |
| LBCD 25 A | | | | | | |
| LBCD 16 A-LS | | | | | | |
| LBCD 40 A-2LS | | | | | | |

LBCR ..

Standard series 3

Linear ball bearings, closed type

LBCR .. A (without seals)

-LS with one seal

-2LS with two seals

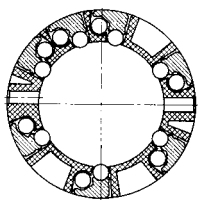
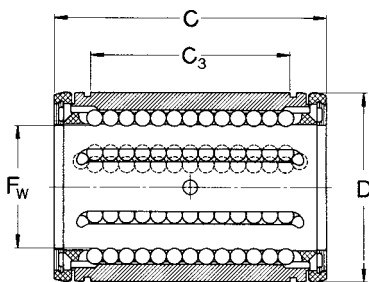

| Designations | Dimensions | | | | Basic load ratings | |
|-----------------|----------------|-----|-----|----------------|--------------------|--------|
| | F _w | D | C | C ₃ | dynamic | static |
| | mm | | | | N | |
| LBCR 5 A | 5 | 22 | 22 | 12 | 280 | 210 |
| LBCR 8 A | 8 | 16 | 25 | 14 | 490 | 355 |
| LBCR 12 A | 12 | 22 | 32 | 20 | 1 160 | 980 |
| LBCR 16 A | 16 | 26 | 36 | 22 | 1 500 | 1 290 |
| LBCR 20 A | 20 | 32 | 45 | 28 | 2 240 | 2 040 |
| LBCR 25 A | 25 | 40 | 58 | 40 | 3 350 | 3 350 |
| LBCR 30 A | 30 | 47 | 68 | 48 | 5 600 | 5 700 |
| LBCR 40 A | 40 | 62 | 80 | 56 | 9 000 | 8 150 |
| LBCR 50 A | 50 | 75 | 100 | 72 | 13 400 | 12 200 |
| LBCR 60 A | 60 | 90 | 125 | 95 | 20 400 | 18 000 |
| LBCR 80 A | 80 | 120 | 165 | 125 | 37 500 | 32 000 |
| Example: | | | | | | |
| LBCR 30 A | | | | | | |
| LBCR 80 A-LS | | | | | | |
| LBCR 60 A-2LS | | | | | | |

N.B.:

All LBC.. A and LBH .. A Linear ball bearings available in corrosion resistant!